

Mnin, Roman temples (and 'Church of Mar Thaqla')

Patron or builder

plan sources

photo sources

other name

location 1.6 km north-east of Mnin, 16 km directly north of Damascus, above the Mnin River.

Oumairi 2001: 74 (Arabic section);

Two rock-cut temples, podium in front with an intervening courtyard. Temple B built first, perhaps dedicated to Jupiter. Temple A is later. Complex transformed later into a church (Byzantine era). Porter provided a full description in *Five Years in Damascus* (London 1855: 326–7). Studied by Syrian team — see Hammoud and Omeri 2010. One of the temples was converted into a church and associated with the legend of Mar Theqla. That association does not seem to date earlier than the late nineteenth century.

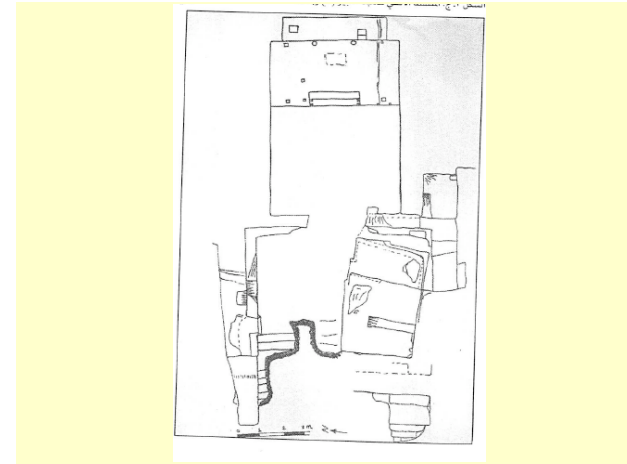

Photo 1 2 3 4 5 6 7 8



keyword temple, church,

date era century category dimensions material

References Ancient Sources Ancient Quotes Roman Unit

Castellana *et al* 2007; Hammoud and Omeri *The Temples of Mnin* Damascus 2010; Oumairi 2001; Porter 1855: 326-7;

WW number Monuments page
Sack number Sauvaget MHD #